



→ Cantilever lift for trucks with trailer coupling

## DH-LV.40 • 1500 - 4000 kg



The **DH-LV** is designed for **trucks with a draw bar coupling** mounted below the vehicle chassis, to function in combination with a **centre-axle trailer**.

It is equipped with an **articulated bumper bar**, that can be lowered to legal bumper height when the truck drives **SOLO** and can be lifted out of way when the trailer is **COUPLED** to the truck. The **DH-LV** allows the operator to load / unload the truck without uncoupling the trailer.

### Lift capacity

CAP	CG	LM
1500 kg	1000 mm	15 kNm
2000 kg	1000 mm	20 kNm
2500 kg	1000 mm	25 kNm
3000 kg	1000 mm	30 kNm
3500 kg	1000 mm	35 kNm
4000 kg	1000 mm	40 kNm

### Weights [see pg. 15]

STEEL platform		ALU platform	
1750 mm	655 kg	1800 mm	535 kg
2000 mm	700 kg	2000 mm	550 kg

Weights incl. CE bumper

# For truck-trailer combinations with draw bar

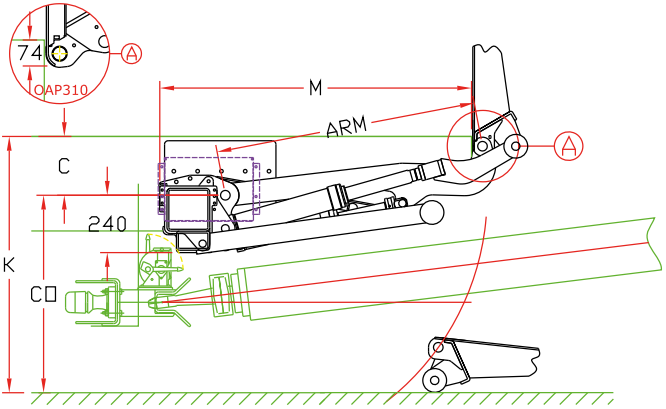

## Fitting dimensions

ARM		1100
K max.		1660
C max.		730
C min.		150
CO max.		930
M	at C max.	1090
M	at C min.	1330

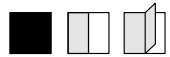

## Technical specifications

Lift frame	Custom made frame mounted between chassis & coupling
Cylinders	2 lift cylinders + 2 tilt cylinders
Type of ride [see pg. 8-9]	Wedged platform. Level ride + automatic tilt at ground level
Platform material	Aluminium or steel (alu = max. 3000 kg)
Platform overlap under floor	-74 mm
Standard platform depths	Steel: 1750 - 2000 mm (max. 4500) Alu: 1800 - 2000 mm (max. 4500)
Standard platform widths	Steel: 2350 - 2480 - 2500 - 2520 - 2550 mm Alu: free up to 2550 in steps of 5 mm
Lift arm lengths	1100 mm
Lift arm widths	1300 mm (other on request)
Standard control unit [see pg. 11]	OAE030.BT
Standard finish of the lift frame	Hot-dip zinc plated finish [OAT104]